

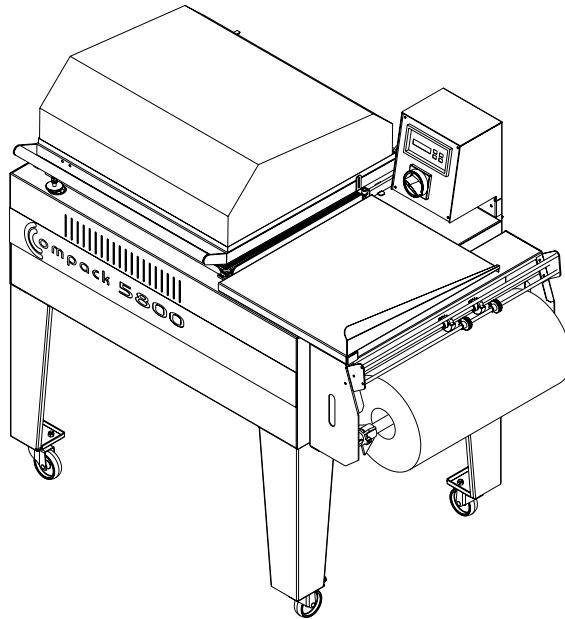

Packaging & Industrial Equipment Ltd

SHRINK WRAP MACHINES

for **compack-i** series



2	Certificate of conformity
3	Service inquiries
3	Warranty
4	Safety information
5	Contents of your package
5	Your machine
6	Mounting the legs
6	Control panel
7	Getting prepared
	<i>Loading the film</i>
	<i>Sealing</i>
	<i>Shrinking</i>
	<i>Magnetic hold down</i>
9	Periodic care
10	Technical specifications
11	Maintenance
11	Troubleshooting
13	Spare part
15	Electrical diagram

EC Declaration of Conformity

According to EC Machinery Directive 89/392/EEC , Annex II A

We herewith declare, as

that the following described machine in our delivered version complies with the appropriate basic safety and health requirements of the EC Machinery Directive 89/392/EEC based on its design and type, as brought into circulation by us. In case of alteration of the machine, not agreed upon by us this declaration will lose its validity.

Description of the machine/machinery part;

Machine Type:

Serial Number:

Applicable EC Directives: (89/392/EWG) I.d.F. 93/44/EWG,
(73/23/EWG), (89/339/EWG) I.d.F. 93/31/EWG

Applicable Harmonized Standards: EN 60204 -1:1992 ; EN 292-1:1991; EN 292-2 A1:1995
EN 294:1992; EN 349:1993; VBG 76:1993; pr EN 415-3:1995

Applicable National Technical
Standard and
Specification: VBG 76

Date / Authorized Signature:

Title of signature:

In case of damage or a service requirement, please contact to your nearest authorized distributor or to the manufacturer company addressed.



MARIPAK Packaging Ltd.

This machine is under the warranty of the manufacturer for a period of one year beginning with the date of delivery. Any interaction related to this warranty will be carried out between the first official invoiced company/person and the authorized distributors.

We hereby guarantee to replace any defected part of the machine in the warranty period. This warranty also covers the repairing of the machine. If the repairing is carried out in the client's plant, the list price for service cost is invoiced to the client which is issued by the manufacturer. The defected part will not be charged. The unit must not be opened by an unauthorized person. It can only be opened by the approval of your authorized distributor. Any defected part must be sent back to the distributor for replacement under warranty.

The manufacturer and the authorized distributor will not be responsible and this warranty will not be valid under these conditions:

- If the machine is not installed properly as described in this manual,
- If the power supply is insufficient or incorrect,
- If anyone is harmed due to improper handling or improper power supply.

- If the consumable parts are demanded or there is a problem related to any consumable part as described below:

Consumable parts: Cutting blade, rubber, teflon tape, blade beds and its corner and side connections.

- If the machine is not used as described in this manual,
- If a change is made on the machine by an unauthorized person.

The manufacturer company will not be responsible for any problem due to translation mistakes.

Safety Information

Please read the following information before connecting your machine to a power supply.

- Plug in the machine to an appropriate voltage as shown on page 15-16.
- Check if the power supply is correct for the necessary connection given in the electrical diagram in this manual.
- Do not touch the sealing blade shown in Figure 1 (number 15) during operation or right after operation.
- Do not touch the back side of the heating chamber which is at the back side of your machine. This part of the unit is hot and might harm.
- Do not lift the mesh hood (number 17) during operation. The fan might cause harm.
- Before plugging in the machine make sure that you have fixed it on a dry and humid-free ground.
- Check the warning signs and labels on the machine.
- Lock the front casters of the table to keep the machine steady.

Please make sure that you have received all the items listed in the following table with your package.

Operating and instructions manual	1 Pcs
Main unit	1 Pcs
Conical film holders	2 Pcs
Film holder bar	1 Pcs
Teflon tape	1 Pcs
Rubber pad	1 Pcs
Cutting and sealing blade	1 Pcs
Allen key to screw conical film holders	1 Pcs
Metal legs with casters	4 Pcs

Your Machine

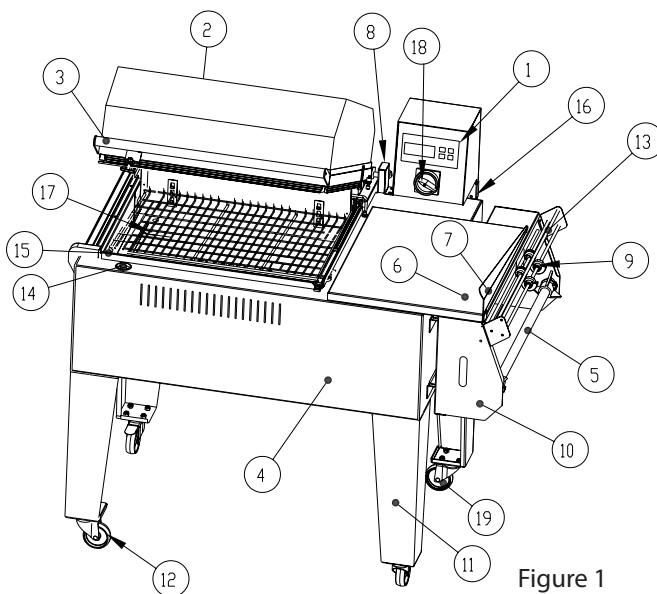

Figure 1

Legends

1. Control panel
2. Transparent hood
3. Handle
4. Main body
5. Film holding bar
6. Working plate
7. Film opener plate side
8. Torsion bar
9. Perforators
10. Film holder
11. Legs
12. Front casters with brake
13. Perforator bars
14. Electromagnet (solenoid)
15. Sealing blade and beds
16. Electrical components (inside)
17. Mesh hood
18. Main on-off switch
19. Back casters (2 pieces)

Mounting The Legs

The outlook of the table and the mounting is shown in the following figures.

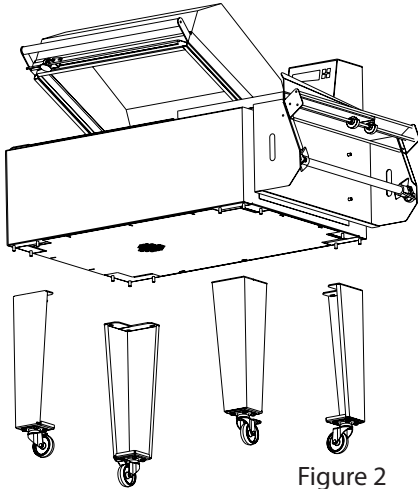

Figure 2

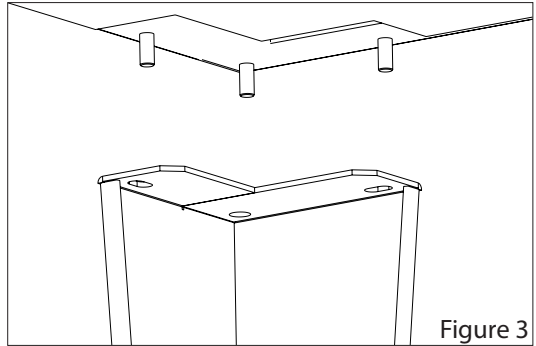
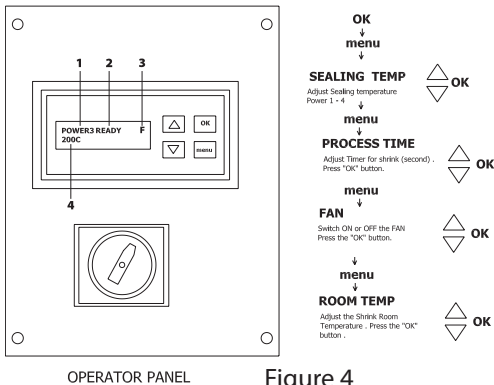

Figure 3

Control Panel

The control panel of the machine is shown in the figure below.

ON-OFF switch,
Digital controller unit



OPERATOR PANEL

Figure 4

Legends

1. Indicates the temperature level of the sealing,
2. Indicates that the machine is ready to run/operate,
3. F mode indicates the 'FAN ON' mode. To disable the FAN and proceed with 'SEAL ONLY' mode, push the OK button.
4. Indicates the actual room temperature.

INFO! In each cycle the room temperature will be exchanged with cooler air. The most accurate temperature values can only be read without packaging process in 5 minutes. Due to this fact, dramatic temperature drops during cycles can be considered as a normal case.

Loading Film

To take out the holders, first remove the film holder bar and then unscrew the conical holders. After one of the sides is fixed, insert the film roll on the bar and screw back the conical head to fix on the roll, as shown in figure 5.

Films are centre-folded and maybe produced either rolled in clockwise or counter clockwise as shown in figure 5. Your machine is capable for either application.

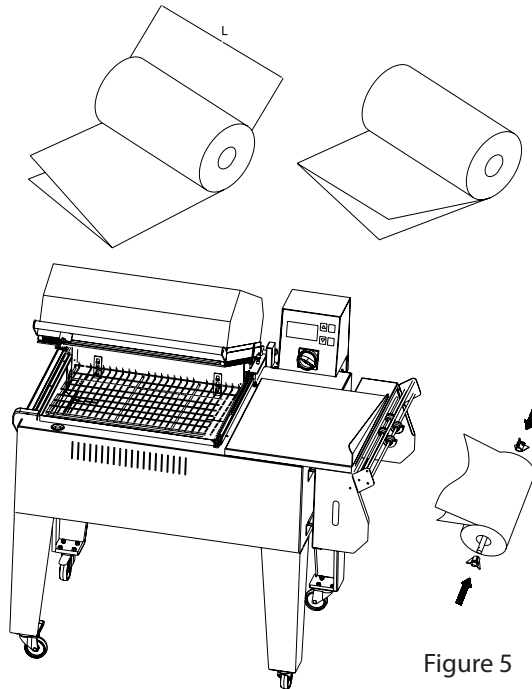

Figure 5

After loading the film, (when mounting the loaded bar) make sure that the opening side of the film faces the front side of the machine (device).

Pull the working plate, the plate which slides back and forth, towards the operator. The film must pass over and under the product plate. (The product plate must remain in between the upper and lower leaves of the film.) As the opening side of the film faces the operator, the product can easily be inserted.

You need to cut and seal the film at least once to start the first packaging. Place your product on the plate together with the film and slide together into the chamber of the machine.

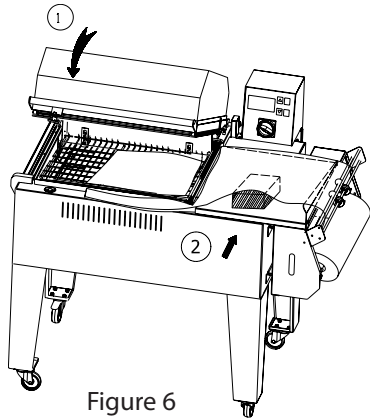

Figure 6

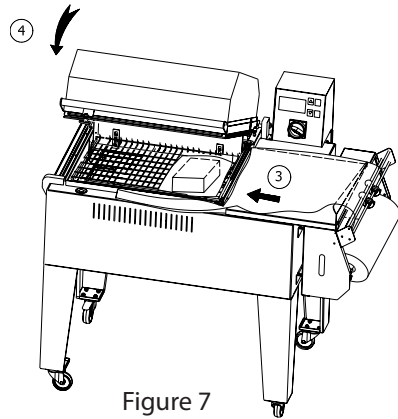

Figure 7

The film and the product must be positioned together close to the front-right corner of the chamber. There must be 1-2 cms of distance between the edge of the chamber and the product.

Close the hood to cut the edges (Figure 6). A small amount of film will be wasted.

IMPORTANT NOTE: To avoid wasting film, you should choose the correct size of film. Film widths are available generally between 20 cm and 60 cm. Sizes vary with increments of 5 cms (ie 20, 25, 30 and so on).

Sealing

One of the functions of the machine is "SEAL ONLY" operation. During this operation the fan won't work. You can wrap the package without shrinkage. To enable or disable the "FAN ON/OFF" mode, just push the OK button (Figure 4, number 3).

Shrinking

The fan and the blade will automatically start functioning as the hood (heating chamber) is closed.

During the process, the fan will accumulate hot air on the package and within a very short time such as 3-5 seconds you can get your package shrunk.

WARNING: Always keep your package on the right corner close to the operator.

Magnetic hold down

Once the hood is closed manually, it will remain closed automatically by the magnetic hold down mechanism. In such models the operator will be available to prepare the next coming package.

WARNING: *Unplug your machine before any periodic care.*

Damage may occur to the acrylic cover if left closed. This will also void your warranty.

The fan chamber in the machine should be checked frequently and any kind of dirt and scrap should be removed.

Remove any residue on the cutting blade and inside the knife bed.

Wipe the transparent hood with a wet cloth. Avoid using any chemicals to remove the dirt which may harm the hood.

Check if the teflon tape on the hood is damaged. If so, replace it with the supplied spare one. This is a self adhesive tape and should be applied as flat as possible.

Check the rubber pad across the sealing blade. If damaged, replace with the spare one supplied with the machine. Insert the new one into the rubber housing channel gently. Please consider the elasticity of the material and do not elongate the pad, otherwise it will be distorted.

Technical Specifications

Models	Available series*	Chamber sizes	Max. film width	Machine weight		Power supply	Consumption (Max/Average)	Machine dimensions axbxcxdx (mm/inches)	Packed dimensions axbxcxdx (mm/inches)	Max. Capacity
				Net	Crated					
COMPACT 4500-i Code: Y12 001 1022	MG	450x320x250mm 17"x13"x9"	400mm 15"	80 kg 176 lbs	112 kg 246 lbs	230V, 15 Amps 1 Phase	3,4/1,9kW	1085x615x1135x865x270 43"x24"x44"x34"x10"	1200x800x800 47"x31"x29"	8-10 packs/min %20 faster in MC model
COMPACT 5800-i Code: Y12 001 1042	MG-MC	580x440x250mm 22"x17"x9"	530mm 21"	109 kg 240 lbs	144 kg 317 lbs	230V 19 Amps 1 Phase	4,4/2,4kW	1227x745x1135x865x270 48"x29"x45"x34"x11"	1200x800x800 47"x31"x29"	
COMPACT 7000-i Code: Y12 001 1062	MG	700x540x250mm 27"x21"x9"	650mm 25"	146 kg 321 lbs	196 kg 432 lbs	230V 22 Amps 1 Phase	4,9/2,7 kW	1499x859x1133x885x270 59"x34"x45"x34"x11"	1740x1040x800 68"x41"x31"	
COMPACT 7000-i Code: Y12 001 1062	MG	810x640x250mm 31"x25"x9"	750mm 29"	158 kg 348 lbs	209 kg 460 lbs	400V 27 Amps 3 Phase	6,2/3,5 kW	1800x980x1135x880x270 79"x38"x45"x34"x11"	1800x1040x900 71"x41"x35"	

* ST: Standard series without magnetic hold down, *MG: Magnetic hold down series, *MC: Automatic discharge series
* Color: RAL 7035 Light gray

Warranty: One year on non-wearable parts

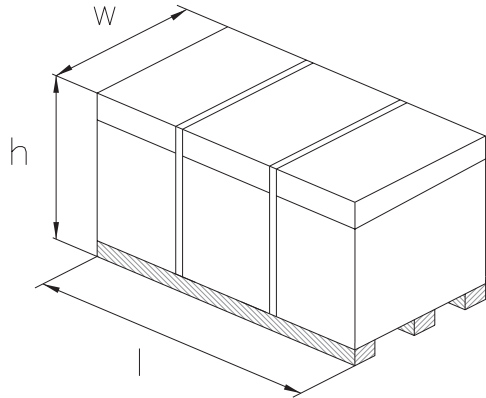
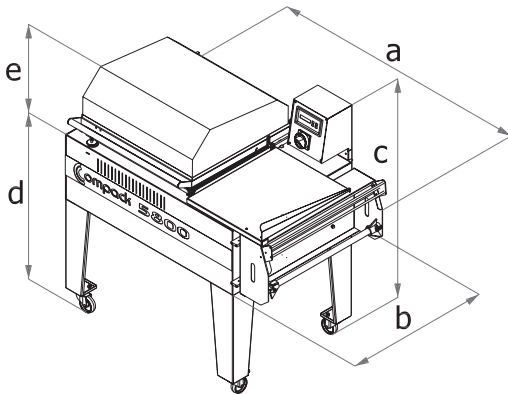

Replacement of the cutting blade

Cutting blade can be broken in time. In order to change it, follow the steps below;

CAUTION: For your safety unplug your unit before any service action. And make sure if the cutting blade is cooled down.

As shown in the Figure 8, there are 3 connection points for the knives. First unscrew the screws with the allen key and then replace the old knife with a new one.

Start screwing No:1, and place the knife properly in its bed. Then fix the spring located on 2 and 3, and re-screw the nuts.

Switch on the machine and check if the cutting blade power is set up correctly on the LCD panel. The over heated knives can be broken much easier. If you think that the knife is set to a high temperature, reduce it immediately to have a longer knife life.

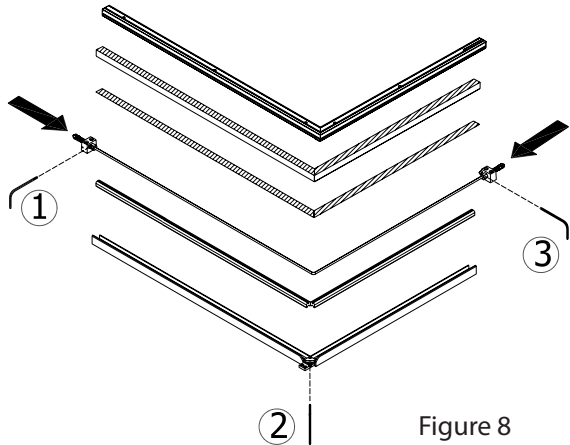

Figure 8

Troubleshooting

If the unit does not start when switched on

- Check if the plug is connected to the energy as shown in the technical description.
- Check if the main switch is ON
- Check the fuse, all switches must be ON

If the fan does not work

- Check if the limit-switch next to the hood has vertical contact to the part together with upper hood.
- Check if the SEAL ONLY function is set to F mode as shown in Figure 4.
- Check if the circuit breaker is 'ON' (see electrical diagram on page 15 or 16).

If the unit does not heat

- Check if the circuit breakers are all 'ON' (see electrical diagram on page 15 or 16).

- Check if the ROOM temperature set value is set to low (Figure 4).

If the unit does not cut

- Check if the cutting blade is broken. If so, change it with the spare one as described in this manual (Figure 8).
- Check the fuse for cutting blade (see electrical diagram on page 15 or 16).
- Check if both ends of the sealing blade are firmly connected to the cable.

If the sealing or cutting quality is poor

- Check if the rubber pad and the teflon ribbon on the upper hood are straight and flat.
- Make sure that you have applied enough hand force to push the hood down with 10-15 kg of pressure.
- Clean the residues around the sealing blade.

If the knife becomes too hot to operate

- Reduce the knife temperature on the control panel.

If the room temperature is too high to make a good shrink

- Reduce the heat on the control panel as shown in Figure 4. It is recommended to start with lower temperature to obtain a good shrink wrap.
- Make sure that the metal flap on the heating room is opening properly at each operation.

If the magnetic hold down does not work properly

- Check the control panel to see if the process time is too short to keep the hood closed (Figure 4).
- If the magnetic system does not touch its counter side on the upper part, then readjust the mechanism on the relevant slots of the upper side. Make sure that the rubber touches the knife 1-2 mms earlier than the magnetic system.
- Check the magnet manually by activating the limit switch to see if the solenoid system can hold any kind of iron part.

If the hood does not open enough or does not open at all

- The torsion bar might be broken or loose. Screw the long bolt clockwise approximately one turn (Figure 1, No 8).

If the sealing line is not at the center of the package height

- Adjust the metal mesh working plate to the vertical center of the package height.

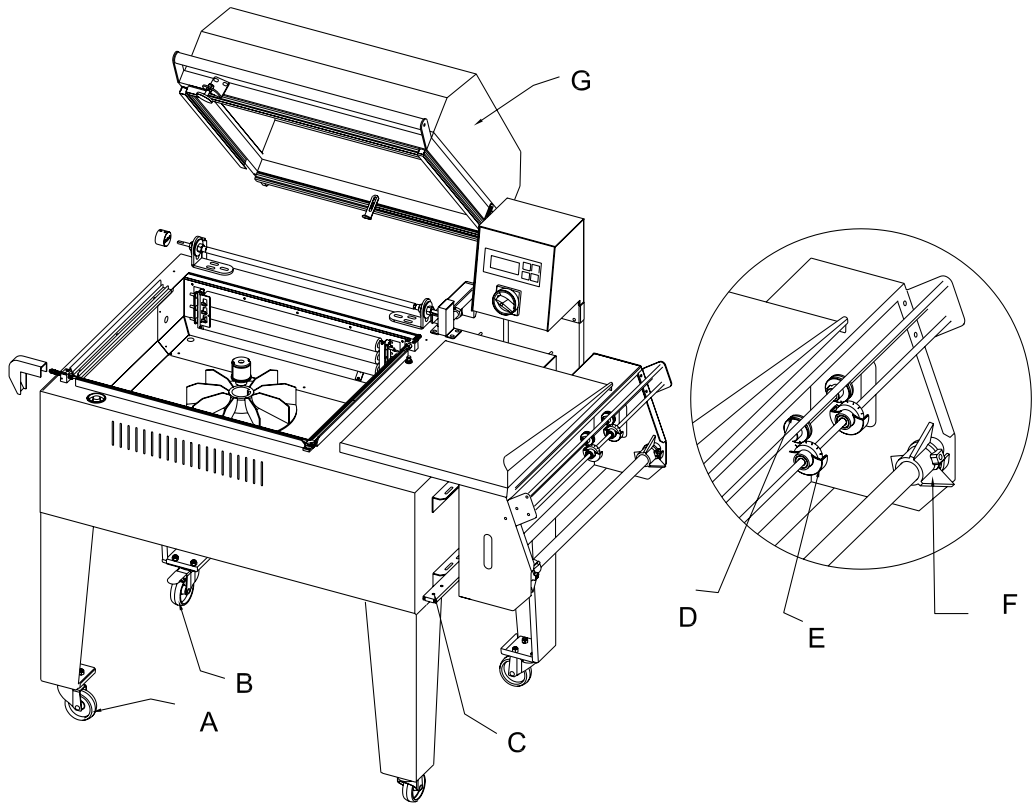

Label	Part Code			Part Name
	model 4500	model 5800	model 7000	
A	Y01 007 0001	Y01 007 0001	Y01 007 0001	Casters with locker EP01 ZKC 075 F
B	Y01 007 0011	Y01 007 0011	Y01 007 0011	Casters EP01 ZKC 075
C	Y01 010 0011	Y01 010 0011	Y01 010 0011	Linear bearings for film holder box
D	Y11 001 3422	Y11 001 3422	Y11 001 3422	Perforater (male)
E	Y11 001 3420	Y11 001 3420	Y11 001 3420	Perforater (female)
F	Y01 003 0042	Y01 003 0042	Y01 003 0042	Film holder cones
G	Y 01 012 0041	Y01 012 0061	Y01 012 0071	Transparent hood

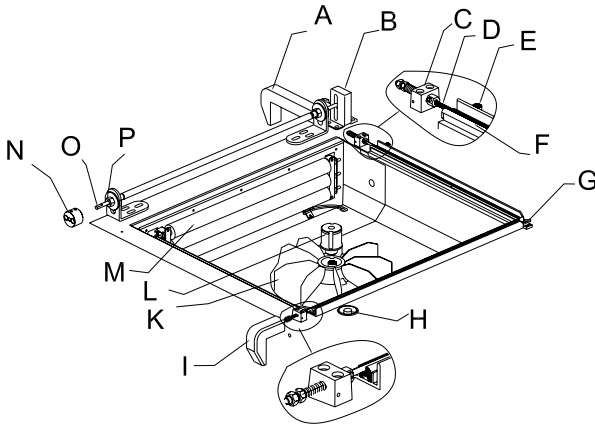

Y02 064 0001
Electronic Controller

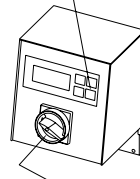

	4500	5800	7000
Fuse	2x16 A	2x20 A	2x20 A
TRF	700 VA	750 VA	800 VA
Resistance WxQuantity	765x3	1040x3	1200x3

Y02 010 0071
Main isolator switch

Label	Part Code			Part Name
	model 4500	model 5800	model 7000	
A	Y01 006 0002	Y01 006 0002	Y01 006 0002	Left blade holder casing (long)
B	Y11 006 0610	Y11 006 0610	Y11 006 0610	Torsion bar cube
C	Y11 001 3400	Y11 001 3400	Y11 001 3400	Left-right blade holder ST&MG (w=24,5mm)
D	Y09 001 0160	Y09 001 0130	Y09 001 0240	Sealing blade
E	Y02 014 0012	Y02 014 0012	Y02 014 0012	Limit switch for fan
F	Y11 001 3472	Y11 001 3462	Y11 001 3482	Ceramic infill group
G	Y11 001 3410	Y11 001 3410	Y11 001 3410	Corner insulating part for blade
H	Y11 002 0020	Y11 002 0020	Y11 002 0020	Magnetic selenoid as full set
I	Y01 006 0001	Y01 006 0001	Y01 006 0001	Left blade holder casing (short)
K	Y01 001 0001	Y01 001 0012	Y01 001 0012	Fan
L	Y03 003 0001	Y03 003 0021	Y03 003 0021	Bushing for motor-fan connection/wedged
M	Y02 007 0081	Y02 007 0092	Y02 007 0041	Heaters (3 pieces/unit)
N	Y03 010 0033	Y03 010 0032	Y03 010 0037	Torsion bar fixer
O	Y01 022 0010	Y01 022 0022	Y01 022 0029	Torsion bar

1

2

3

4

5

6

7

8

A

B

C

D

E

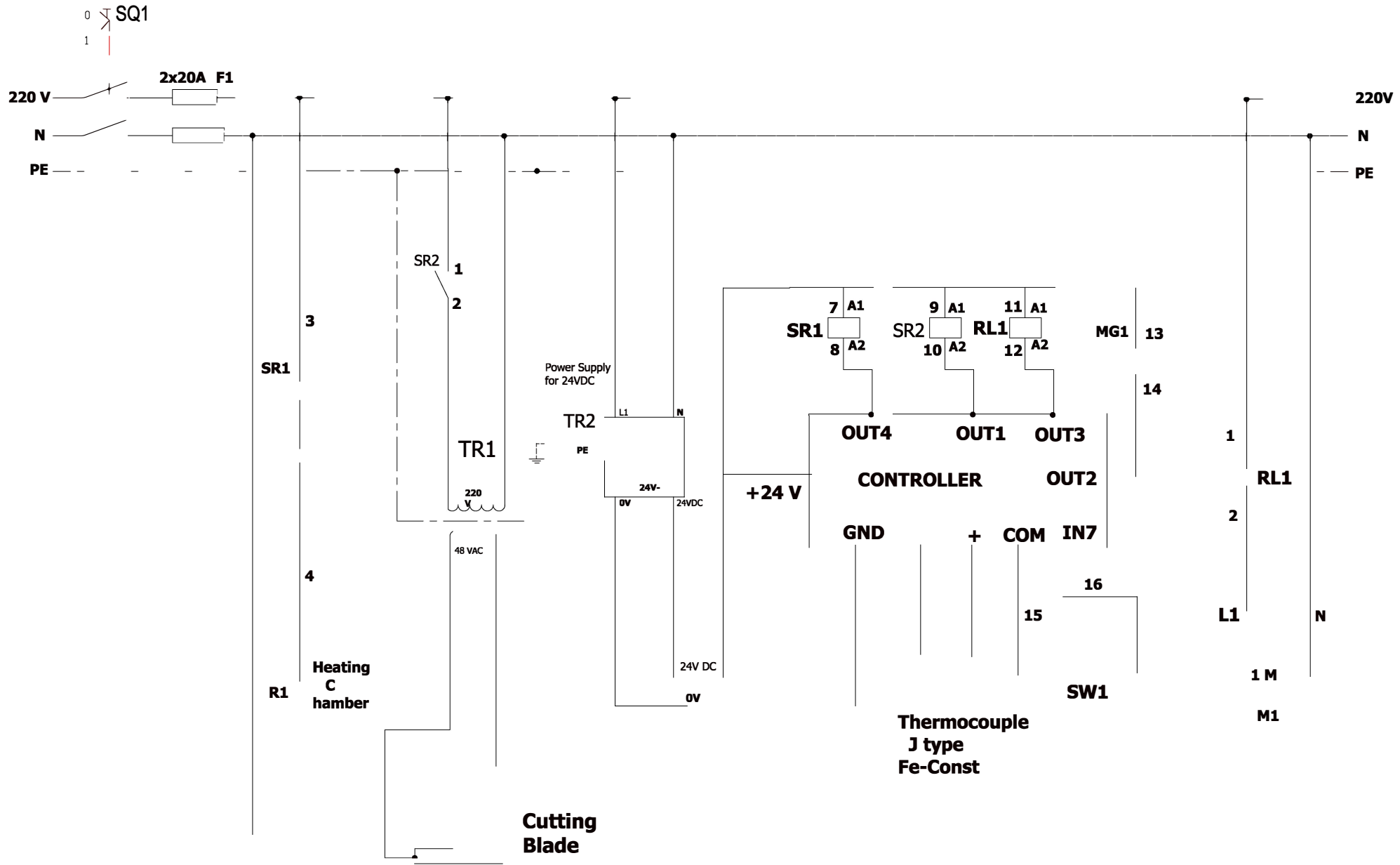

MODEL : COMPACK CP01
 VOLT : 230V 50Hz
 POWER : 2,5KWA

GIDA END.MAM.SAN.TIC.LTD.STI.

ATTENTION:THIS DOCUMENT
 CONTAINS PROPRIETARY DATA OF
 MARIPAK
 NO DISCLOSURE,REPRODUCTION
 OR USE OF ANY PART OF THIS
 DOCUMENT MAY BE WITHOUT
 WRITTEN PERMISSION

A4
 Scale
 FULL

PRODUCT INDEX
 Drawn by
 Date B 03.09.200
 Checked
 Date B 15.01.2010

TITLE

Y11 002 0060
 COMPACK i CP01

Edition / Date
 C / 15.01.2010

Sheet 1 of 2

1

2

3

4

5

6

7

8

A

B

C

D

E

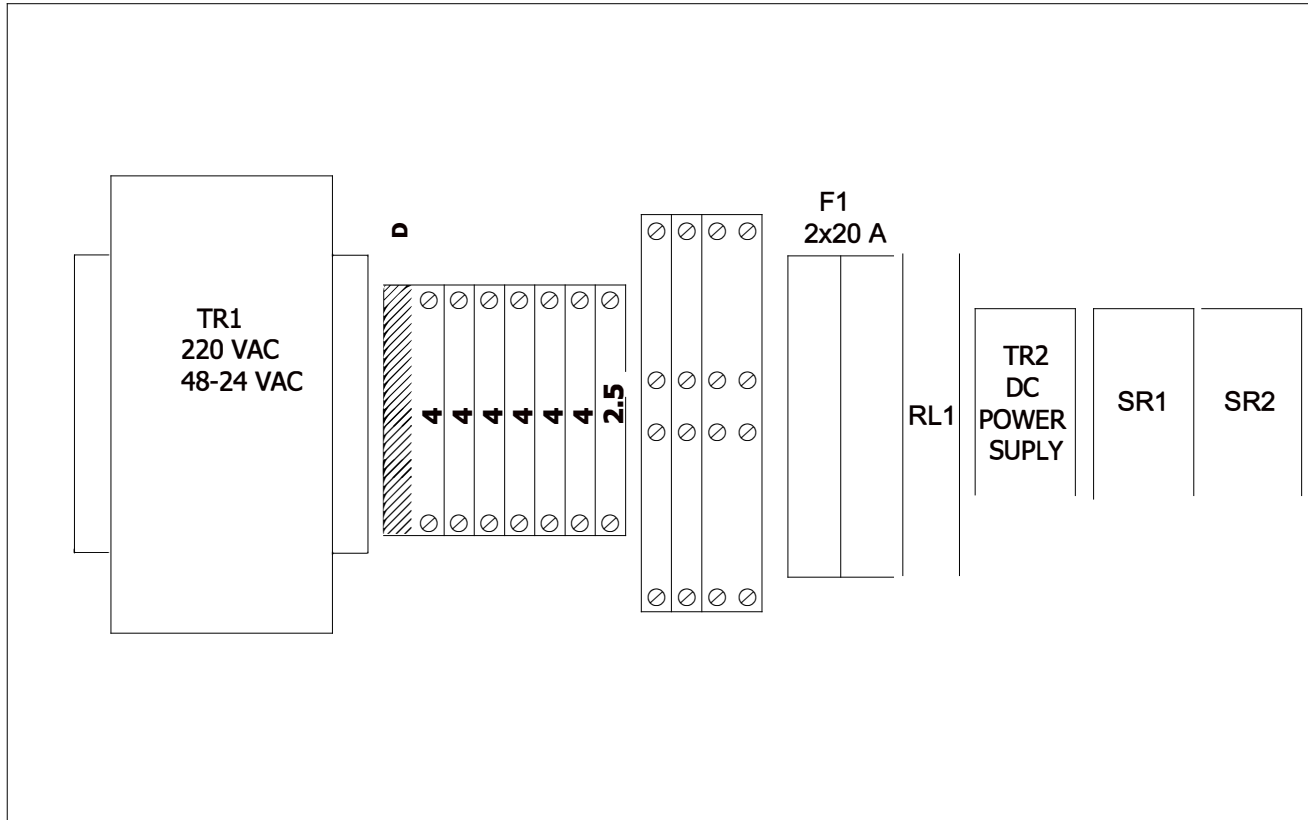

LAY OUT

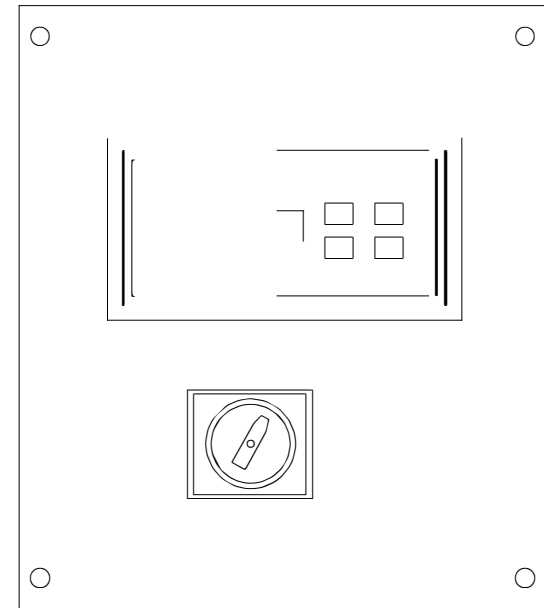

OPERATOR PANEL

GIDA END.MAM.SAN.TIC.LTD.STI.	ATTENTION:THIS DOCUMENT CONTAINS PROPRIETARY DATA OF MARIPAK NO DISCLOSURE,REPRODUCTION OR USE OF ANY PART OF THIS DOCUMENT MAY BE WITHOUT WRITTEN PERMISSION	A4	PRODUCT INDEX	TITLE Y11 002 0060 COMPACK i CP01	Edition / Date	
		Scale FULL	Drawn by Date 29.01.2007 Checked Date 15.01.2010		C / 15.01.2010	Sheet 2 of 2

Packaging & Industrial Equipment Ltd